

Welcome to the Acropolis Museum

Café & Restaurant

- Café on the ground floor, behind the Shop.
- Restaurant on the 2nd floor.
- Last orders accepted 30 minutes prior to the Museum's closing time.
- Every Friday and Saturday evening, the restaurant remains open until midnight.

Shops

- Souvenirs and gifts, on the ground floor.
- Bookshop, on the 2nd floor.
- Shops close 15 minutes prior to the Museum's closing time.

Families





- Children's strollers for loan, available at the cloakroom, on the ground floor.
- Parent's room for personal care of babies and small children, on the 1st floor.
- Kids Corner on the 2nd floor, next to the restaurant.
- Family audio guide handsets on request at the Information Desk.
- Family backpacks and family trails, at no charge, available at the Information Desk.

Adults

- Audio guide handsets on request at the Information Desk.
- Information about gallery talks offered by the Museum's Archaeologist-Hosts is available at the Information Desk.
- Multimedia Center on the small balcony on the 2nd floor.

Please

For the safety and security of the exhibits

-  Leave large purses and bags at the cloakroom.
-  Do not touch the exhibits.
-  Do not bring food or drinks into the exhibition galleries.
-  No photography or videos in the Archaic Acropolis Gallery, for the protection of the sculptures.
-  Set your mobile telephones to silent and avoid their use while touring the exhibition galleries.

Accessibility

- The archaeological excavation is accessible from the Museum's entrance courtyard.
- Ramps for wheelchair and stroller access at the Museum's entrances.
- Elevator access and WCs for disabled people on all levels.
- Wheelchairs for loan: inquire at the Information Desk on the ground floor.
- Short guide to the Museum in Braille available from the Information Desk.
- Guide dogs accompanying people with disabilities are welcome.

Information

Inquire at the Information Desk on the ground floor for general information and details of the Museum's other activities.

Acropolis Museum
Dionysiou Areopagitou 15
Athens 11742
Tel.: 210 9000900
info@theacropolismuseum.gr
www.theacropolismuseum.gr



Opening hours and tickets

Winter season (1 November – 31 March)

Monday to Thursday
09:00 – 17:00
Friday
09:00 – 22:00
Saturday & Sunday
09:00 – 20:00

Archaeological excavation site:

Monday to Sunday
09:00 – 17:00

General admission: 5 euros
Reduced admission: 3 euros

Last admission
30 minutes prior to
the Museum's closing time

Closed

1 January,
Easter Sunday,
1 May, 25 December,
26 December

Limited hours

Christmas Eve
& New Year's Eve
09:00 – 15:00,
Orthodox Good Friday
12:00 – 18:00,
Orthodox Holy Saturday
08:00 – 15:00

Summer season (1 April – 31 October)

Monday
08:00 – 16:00
Tuesday to Sunday
08:00 – 20:00
Friday
08:00 – 22:00

Archaeological excavation site:

Monday: 08:00 – 16:00
Tuesday to Sunday: 08:00 – 20:00

General admission: 10 euros
Reduced admission: 5 euros

**Extended closing time,
until midnight**
Evening of August full moon,
European Night of Museums

Free admission days
6 March, 25 March, 18 May,
28 October



Photo: West frieze of the Parthenon. Block X: two young knights enthusiastically galloping

Discover 22 of the Museum's most beloved exhibits using this guide map, in about 2 hours.

map of the acropolis museum

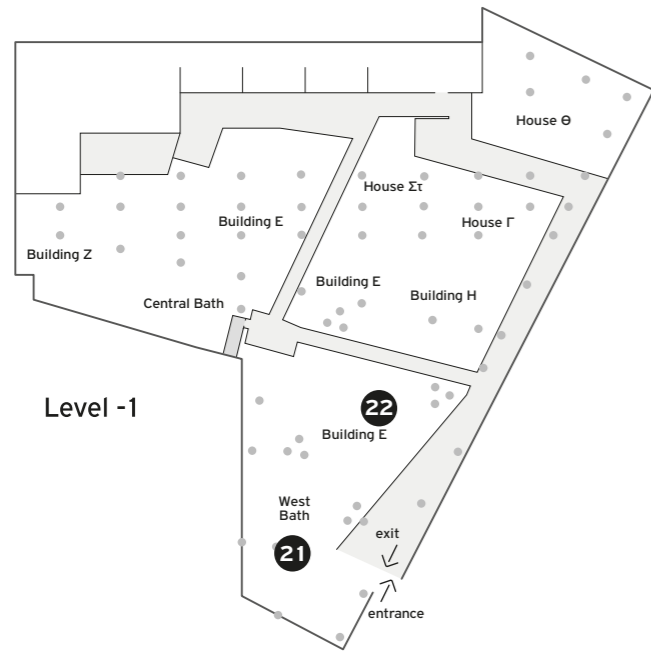

Archaeological excavation



21. View of the archaeological excavation site beneath the Museum



22. The circular tower-hall in Building E. Early 6th cent.

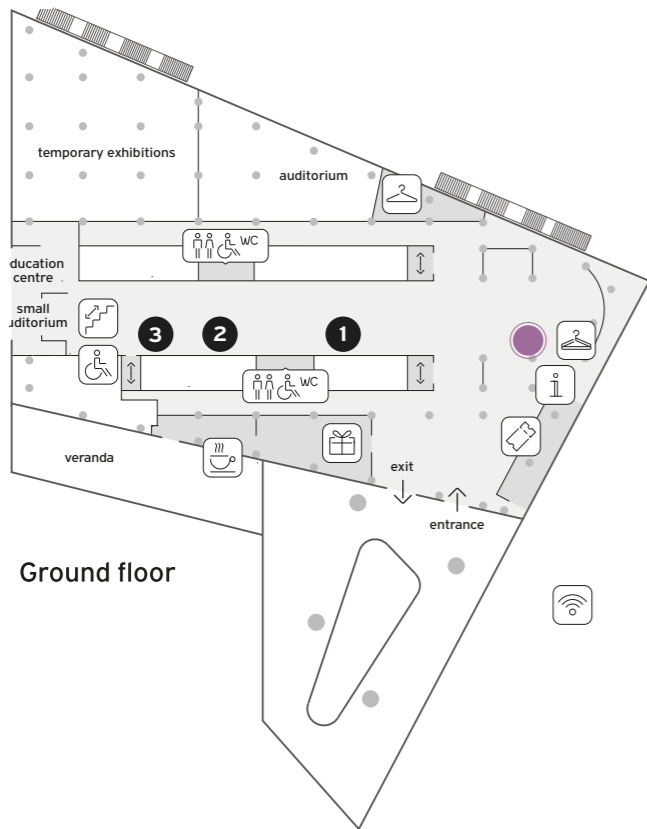

Acropolis Slopes



1. Black-figure loutrophoros



2. Pillar with a dedication to Asklepios



3. Papposilenos

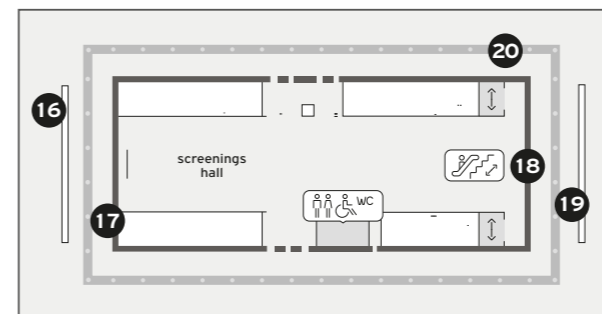
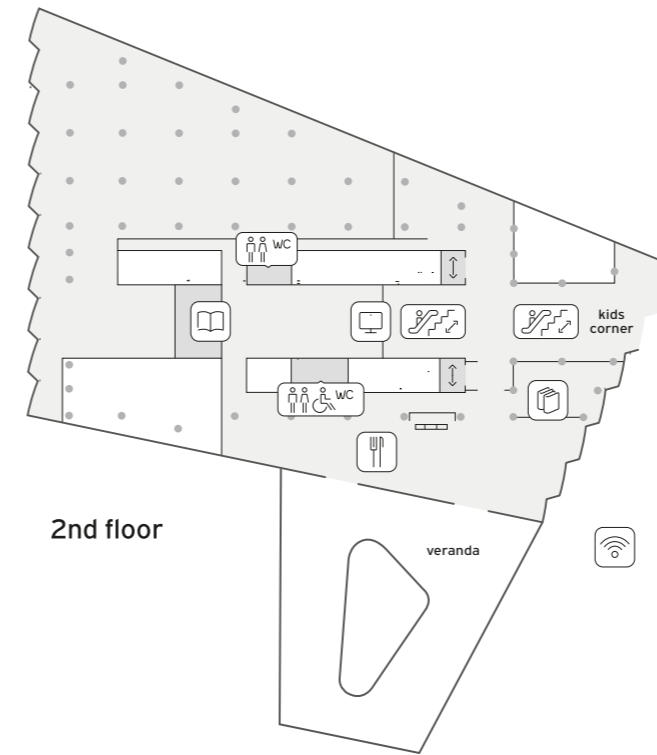
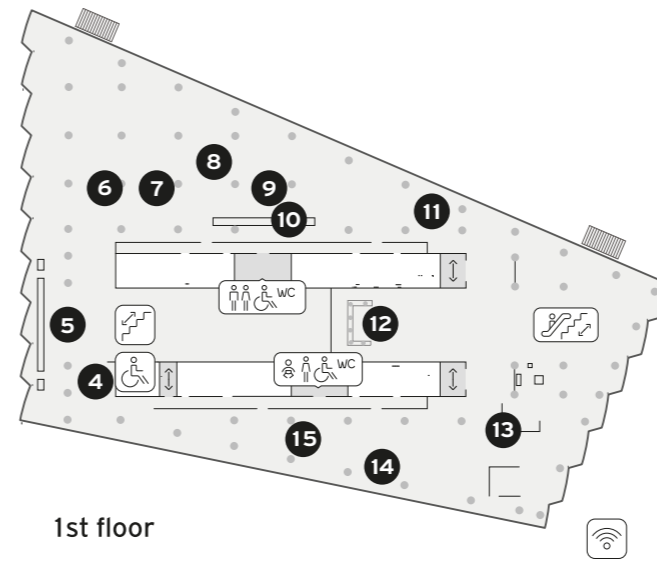

Acropolis 13th - 7th cents. BC



4. Bronze disk with Gorgon

Archaic Acropolis



5. Pediment of the Hekatompedon



6. Calf-Bearer



7. Peplos Kore



8. Rampin Rider



9. Antenor Kore



10. Gigantomachy Pediment



11. Kritios boy

Erechtheion



12. The Karyatids, Erechtheion

Athena Nike



13. The winged goddess Nike

5th cent. BC - 7th cent. AD



14. Decrees honouring the Samians



15. Portrait of Alexander the Great

Parthenon



16. East Pediment



17. East Frieze, Block VI



18. West Frieze, Block VIII



19. West Pediment



20. South Metope 1

- exhibits
- you are here
- tickets
- information desk
- shop
- café
- elevator
- stairs
- escalator
- toilets
- parents' room
- cloakroom
- groups' cloakroom
- men's toilets
- women's toilet
- wheelchair access
- reading lounge
- wi-fi
- restaurant
- bookshop
- multimedia center